

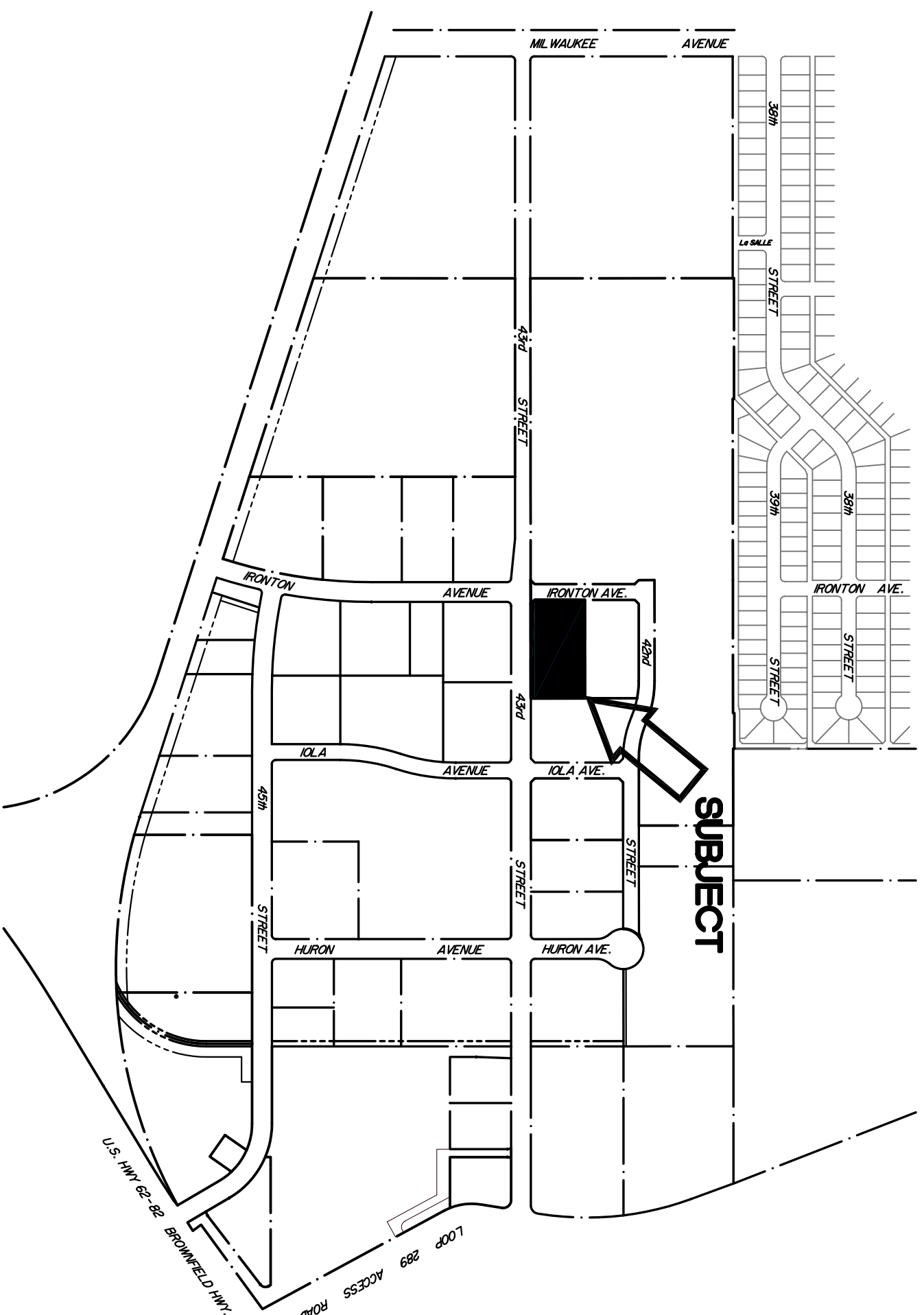

REVISIONS: 11/17/2008

- 1 CHANGED (2) F.D. TWO (2) CAST IRON F.S. & (1) STANDARD F.S. IN ROOM 117, SEE SHTS. A1 & P1.
- 2 MOVED BOTH SAFETY-SHOWERS IN ROOMS 118, & 125 CHANGED TO PROVIDED BY TENANT & ADD (1) HORIZ. SHOWER ABOVE KNEE OPERATED SINK IN ROOM 132, SEE SHT. A1 FOR LOCATIONS.
- 3 REMOVED (2) 6" MTL. STUDS SPANNING SHORT DIST. & OF ROOM FOR BRACING OF PROTECTION SYSTEM. ADDD BASE IN ROOMS 128 & 130 SEE SHT. A3 FOR DTLS.
- 4 CHANGED SPEC FOR F1 ON FINISH LEGEND, SEE SHT. A3.
- 5 ADDED ALTERNATE FOR F2 ON FINISH LEGEND, SEE SHT. A3.
- 6 ADDED NOTES 1 & 2 BELOW FINISH LEGEND, SEE SHT. A3.
- 7 CHANGED ADA CLOSURE ON DOOR 112B TO HOLD-OPENED CLOSURE ON DOOR SCHED. SEE SHT. A3.
- 8 ADDED DOOR #9 128B & 130, SEE DOOR SCHED. ON SHT. A3.
- 9 ADDED STL. GUARD RAIL IN ROOMS 120-122, SEE DTLS. 8, 9, & 10 ON SHT. A4b.
- 10 ADDED SEPARATE UPPER & LOWER SWITCHING FOR TISSUE CULTURE ROOMS 120-122, AS SHOWN ON DTLS 11-A4b.
- 11 PAPER TOWEL, TOLLET PAPER, & SOAP DISP. PROVIDED BY TENANT & INSTALLED BY OWNER, SEE SHT. A5.
- 12 SPLIT SHT. A7 INTO (2) SHTS. A7a & A7b, SEE SHADGED BOXES FOR ALL EQUIP. CHANGES & ADDED COLUMNS WATER SUPPLY, DRAIN, & PROVIDE/CONNECT.
- 13 CHANGED OUTLET ABOVE EQUIP. #57 TO DED OUTLETS IN ROOMS 117 & 132, SEE SHT. E1.
- 14 ADDED (2) J-BOXES FOR EQUIP. #10 & #92 IN ROOMS 119, & 125 RESPECTIVELY, SEE SHT. E1 FOR LOCATIONS.
- 15 CHANGED (3) OUTLETS ON EAST SIDE OF WEST MOST ISLAND TO BE DED OUTLETS, SEE SHT. E1.
- 16 ADDED DATA BOX FOR COPPER IN ROOM 100, SEE SHT. E1.
- 17 ADDED FIRE PULLS TO ROOMS 100 & 126, SEE SHT. E1 FOR LOCATIONS.
- 18 ADDED DUPLEX FOR CIRC. PUMP IN ROOM 127, SEE SHT. E1 FOR LOCATION.
- 19 ADDED ALARM PANEL & IEL MAX. 3 PANEL IN ROOM 104, SEE SHT. E1 FOR LOCATIONS.
- 20 ADDED HORN STROBE TO ROOM 100, SEE SHT. E1 FOR LOCATION.
- 21 (2) QUADS. & (1) DUPLEX CHANGED TO DED DUPLEXES IN ROOM 104, SEE SHT. E1.
- 22 CHANGED (6) DUPLEXES TO DED DUPLEXES AS SHOWN IN ROOMS 123, 125 & 132, SEE SHT. E1.
- 23 NEW DUPLEX IN ROOM 117 BY EQUIP. #53, SEE SHT. E1.
- 24 CHANGED POWER POLES IN ROOM 100 TO PROVIDED BY TENANT, CONNECTED BY ELECTRICIAN, SEE SHT. E1.
- 25 CHANGED POWER POLE IN ROOM 119 TO A FLOOR MOUNTED BOX, SEE SHT. E1.
- 26 MOVED THERMOSTATS IN ROOMS 119, 125 & 126, SEE SHT. E1 FOR NEW LOCATIONS.
- 27 ADDED SMOKE DETECTORS IN ROOMS 100, 118, 123, 125, & 126, SEE SHT. E1 OR E2 FOR LOCATIONS.
- 28 ADDED NOTE #7 ON SHT. E1.
- 29 CHANGED (3) EXT LIGHTS TO INCLUDE BATTERY PACK LIGHTING, SEE SHT. E2.
- 30 ADDED (2) 3-WAY SWITCHES IN ROOMS 111 & 117, SEE SHT. E2.
- 31 CHANGED (1) SWITCH IN ROOM 126 TO MAKE ALL SWITCHES 4-WAY, SEE SHT. E2.
- 32 CHANGED (3) SWITCHES FOR TISSUE CULTURE ROOMS TO INCLUDE INDICATOR LIGHTS, SEE SHT. E2.
- 33 ADDED FAN SWITCH FOR DARK ROOM 133, SEE SHT. E2.
- 34 CHANGED DRYWALL CEILINGS IN ROOMS 132 & 133 TO LAY-IN CEILINGS, SEE SHT. E2.
- 35 ADDED (3) GAS LINES TO ROOMS 123 & 124, SEE SHT. M1 FOR LOCATIONS.
- 36 REMOVED (6) 12"x12" LOWER VENTS FROM EXTERIOR TILT WALL, SEE SHT. M1.
- 37 ADDED DTL. 1-M1 BLOWER DTL., ALL EQUIP., PIPING, FITTINGS PROVIDED BY TENANT & INSTALLED BY HVAC CONTRACTOR, SEE SHT. M1.
- 38 MODIFIED MECHANICAL NOTE #9 AS SHOWN, SEE SHT. M1.
- 39 ADDED MECHANICAL NOTE #10, SEE SHT. M1.
- 40 ADDED WATER SYSTEM DIAGRAM & LEGEND, SEE SHT. P1.
- 41 CHANGED SPEC. FOR #9 ON FIXTURE SCHED. ON SHT. P1.
- 42 ADDED NOTE #2 ON FIXTURE SCHED. ON SHT. P1.
- 43 ADDED 10" SAMPLING PORT AS PER CITY OF LUBBOCK, SEE SHT. P1.
- 44 SEPARATED BATHROOM SEWER LINES FROM REST OF BUILDING FOR SAMPLING PORT SEE SHT. P1.
- 45 ADDED CHASES FOR HVAC REF. LINES, SEE SHTS. A1 & M1.
- 46 ADDED NETWORK CONTROLLER XC-S942/CLK W/ (2) XC-T8C TERMINAL BOARDS W/ CASE & XC-LAN232 LAN ADAPTER, SEE SHT. E1.
- 47 ADDED FILTER RACK REQUIREMENTS NOTE #11 ON SHT. M1.
- 48 CHANGED HVAC UNIT #7 FROM A 5 TON TO A 10 TON UNIT.

LOT 32 - SUITE 500 6112 43rd STREET LUBBOCK, TEXAS 79407 11/17/2008



SHEET INDEX		
SH. NO.	DESCRIPTION	DATE
T1	TITLE SHEET	11/17/2008
A1	FLOOR PLAN	11/17/2008
A2	INTERIOR WALL SECTIONS	10/24/2008
A3	DOOR & FINISH SCHEDULES	11/17/2008
A4a	WALLWORK ELEVATIONS & DETAILS	10/24/2008
A4b	INTERIOR ELEVATIONS & SECTIONS	11/17/2008
A5	INTERIOR ELEVATIONS & SECTIONS	11/17/2008
A6	EQUIPMENT PLAN	11/17/2008
A7a	EQUIPMENT SCHEDULE	11/17/2008
A7b	EQUIPMENT SCHEDULE CONTINUED	11/17/2008
A8a	CABINET DRAWINGS & SIGNAGE	11/17/2008
A8b	CABINET DRAWINGS	11/17/2008
A8c	CABINET DRAWINGS	11/17/2008
A8d	SCOPE OF WORK	11/17/2008
A9	ELEVATIONS	11/17/2008
E1	ELECTRICAL PLAN & RISER	11/17/2008
E2	REFLECTED CEILING PLAN	11/17/2008
M1	MECHANICAL PLAN	11/17/2008
P1	PLUMBING PLAN	11/17/2008

LOCATOR PLAN
 SCALE: 1" = 500'

EXHIBIT "G-1"

Wilkerson

PROPERTIES INC.

Commercial & Industrial
Development, Management & Brokerage
Phone: (806) 474-2223
Fax: (806) 474-2216
501 E. 66th Street
Lubbock, Texas 79404

SANTA FE PARK-LOT 32-SUITE 500
6112 43rd Street
Lubbock, Texas 79407

Date: 10/24/2008
Drawn by: JMT, JMS, MRK
Checked by:

Rev: 11/17/2008

Notes:

Aeco:

Approved by	
 Boyer CropScience Santa Fe 32 LP	 Lubbock Santa Fe 32 LTD.

T1